

Breaker connect module External power supply 24...48 V DC Accessories for circuit breaker 3WL10 / 3VA27

**Model**

product brand name	SETRON
product designation	breaker connect Module
design of the product	External power supply, 24...48V DC

**Mechanical Design**

height	61 mm
width	90 mm
depth	140 mm
net weight	0.14 kg

**Approvals Certificates**

General Product Approval	Marine / Shipping	other
--------------------------	-------------------	-------



[Confirmation](#)



[Miscellaneous](#)

other	Environment
-------	-------------

[Confirmation](#)

[Environmental Confirmations](#)

**Further information**

- Information on the packaging  
<https://support.industry.siemens.com/cs/ww/en/view/109813875>
- Information- and Downloadcenter (Catalogs, Brochures,...)  
<http://www.siemens.com/lowvoltage/catalogs>
- Industry Mall (Online ordering system)  
<https://mall.industry.siemens.com/mall/en/en/Catalog/product?mlfb=3VW9011-0AT07>
- Service&Support (Manuals, Certificates, Characteristics, FAQs,...)  
<https://support.industry.siemens.com/cs/ww/en/ps/3VW9011-0AT07>
- Image database (product images, 2D dimension drawings, 3D models, device circuit diagrams, ...)  
[http://www.automation.siemens.com/bilddb/cax\\_en.aspx?mlfb=3VW9011-0AT07](http://www.automation.siemens.com/bilddb/cax_en.aspx?mlfb=3VW9011-0AT07)
- CAx-Online-Generator  
<http://www.siemens.com/cax>
- Tender specifications  
<http://www.siemens.com/specifications>

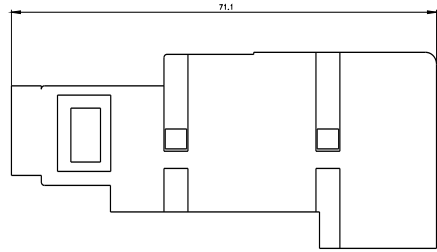
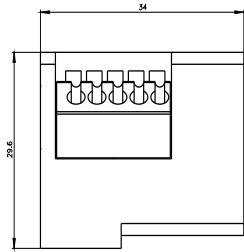

---

last modified:

8/10/2021 

